

SHIRE OF LAVERTON

Directional Road Closure -
SINGLE LANE, UNDIVIDED ROADWAY
Equipment & Workers between 1.2m - 3m of Traffic

SITE SPECIFIC NOTES:

1. ALL SIGN LOCATIONS ARE TO BE CHECKED ON SITE PRIOR TO SETOUT AND POSITIONS ADJUSTED TO ALLOW FOR SITE SPECIFIC CONSTRAINTS SUCH AS VEGETATION, OTHER SIGNS AND ROAD SIDE FURNITURE.
2. CONFLICTING SIGNS TO BE COVERED WITH SUITABLE OPAQUE MATERIAL DURING WORKS.
3. CONE SPACING: 12m
4. AFTER INSTALLATION A DRIVE THROUGH INSPECTION IS TO BE CONDUCTED AND SIGNS ADJUSTED FOR MAXIMUM EFFECTIVENESS.

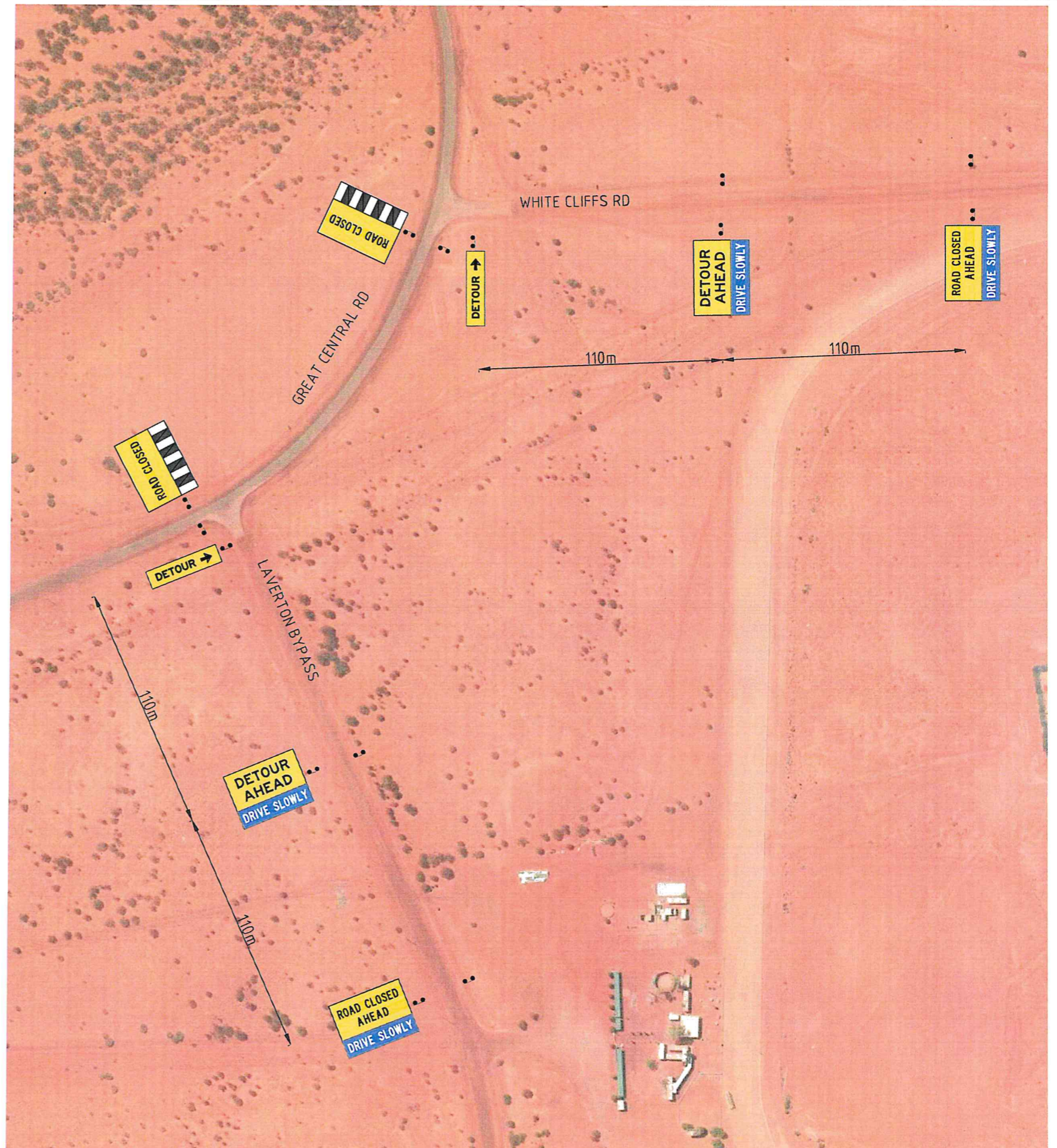

ISSUE	DESIGNER	DATE	AMENDMENT DESCRIPTION
0	B.L	04/03/2025	INITIAL RELEASE

EVOLUTION
4 BETETE STREET, WELSHPOOL, WA, 6106
PHONE - 1300 880 481

CLIENT:  SHIRE OF LAVERTON
Dispersing the Connected Spirit

DRAWN BY:
BIANCA LENNOX

DESIGNED BY:
BIANCA LENNOX

REVIEWED BY:
STEVEN ROBERTS

ACCREDITATION:
AWTM-23-12766-03

ACCREDITATION:
AWTM-23-12766-03

ACCREDITATION:
KTS-AWTM-23-51067-02

SIGNATURE: 

SIGNATURE: 

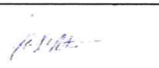
SIGNATURE: 

PROJECT LOCATION:
LAVERTON BYPASS,
LAVERTON

TITLE:
REMEDICATION WORKS

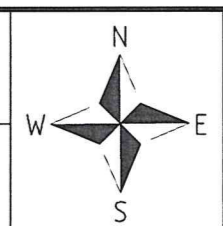

PROJECT NUMBER: 44.1073298
SHEET NUMBER: 01
REVISION NUMBER: 0

SHIRE OF LAVERTON

Directional Road Closure
 SINGLE LANE, UNDIVIDED ROADWAY
 Equipment & Workers between 1.2m - 3m of
 Traffic

SITE SPECIFIC NOTES:

1. ALL SIGN LOCATIONS ARE TO BE CHECKED ON SITE PRIOR TO SETOUT AND POSITIONS ADJUSTED TO ALLOW FOR SITE SPECIFIC CONSTRAINTS SUCH AS VEGETATION, OTHER SIGNS AND ROAD SIDE FURNITURE.
2. CONFLICTING SIGNS TO BE COVERED WITH SUITABLE OPAQUE MATERIAL DURING WORKS.
3. CONE SPACING: 12m
4. AFTER INSTALLATION A DRIVE THROUGH INSPECTION IS TO BE CONDUCTED AND SIGNS ADJUSTED FOR MAXIMUM EFFECTIVENESS.

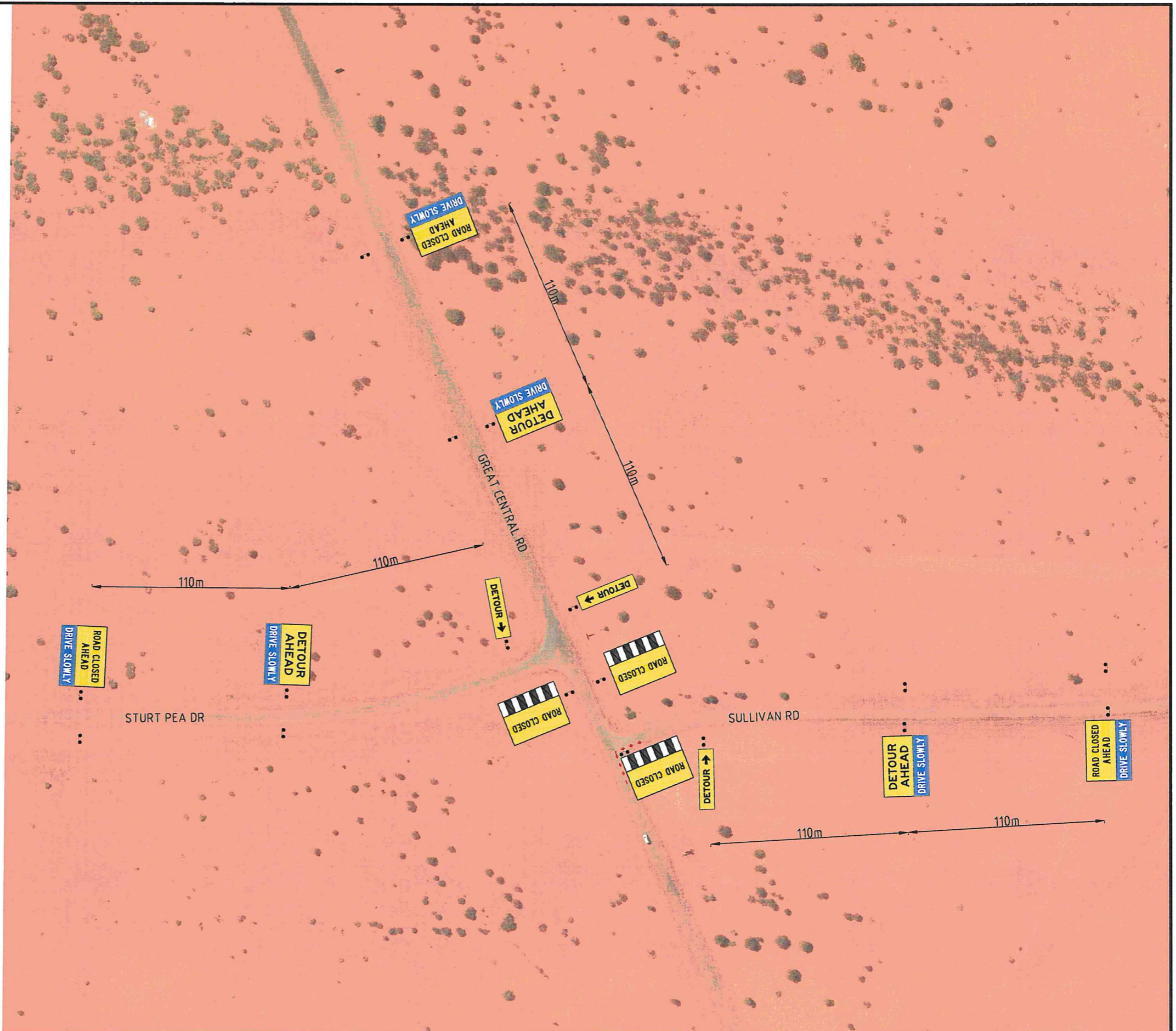

ISSUE	DESG	DATE	AMENDMENT DESCRIPTION
0	B.L	04/03/2025	INITIAL RELEASE

EVOLUTION
 4 BETETE STREET, WELSHPOOL, WA, 6106
 PHONE - 1300 880 481

CLIENT: 

DRAWN BY:
 BIANCA LENNOX

DESIGNED BY:
 BIANCA LENNOX

REVIEWED BY:
 STEVEN ROBERTS

ACCREDITATION:
 AWTM-23-12766-03

ACCREDITATION:
 AWTM-23-12766-03

ACCREDITATION:
 KTS-AWTM-23-51067-02

SIGNATURE: 

SIGNATURE: 

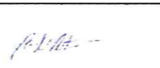
SIGNATURE: 

PROJECT LOCATION:
 LAVERTON BYPASS,
 LAVERTON

TITLE:
 REMEDIATION WORKS

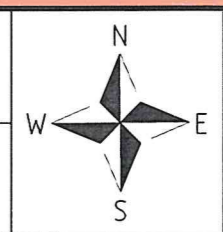

PROJECT NUMBER: 441073298
SHEET NUMBER: 02
REVISION NUMBER: 0

SHIRE OF LAVERTON

Directional Road Closure
 SINGLE LANE, UNDIVIDED ROADWAY
 Equipment & Workers between 1.2m - 3m of
 Traffic

SITE SPECIFIC NOTES:

1. ALL SIGN LOCATIONS ARE TO BE CHECKED ON SITE PRIOR TO SETOUT AND POSITIONS ADJUSTED TO ALLOW FOR SITE SPECIFIC CONSTRAINTS SUCH AS VEGETATION, OTHER SIGNS AND ROAD SIDE FURNITURE.
2. CONFLICTING SIGNS TO BE COVERED WITH SUITABLE OPAQUE MATERIAL DURING WORKS.
3. CONE SPACING: 12m
4. AFTER INSTALLATION A DRIVE THROUGH INSPECTION IS TO BE CONDUCTED AND SIGNS ADJUSTED FOR MAXIMUM EFFECTIVENESS.

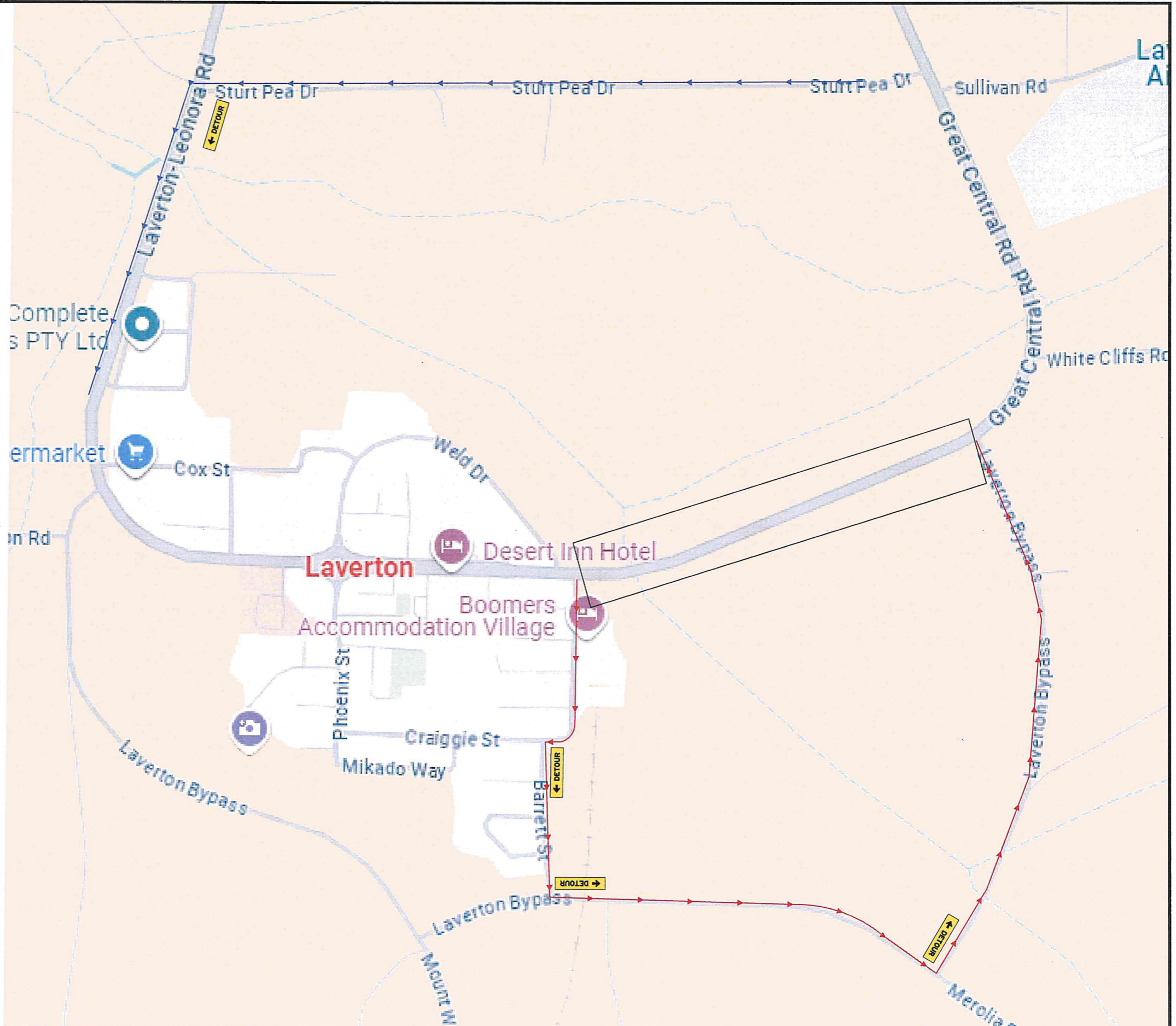

ISSUE	DESIGN	DATE	AMENDMENT DESCRIPTION
0	B.L	04/03/2025	INITIAL RELEASE

EVOLUTION
 4 BETETE STREET, WELSHPOOL, WA, 6106
 PHONE - 1300 880 481

CLIENT:

SHIRE OF LAVERTON
 Discover the Outback Spirit

DRAWN BY:
 BIANCA LENNOX

DESIGNED BY:
 BIANCA LENNOX

REVIEWED BY:
 STEVEN ROBERTS

ACCREDITATION:
 AWTM-23-12766-03

ACCREDITATION:
 AWTM-23-12766-03

ACCREDITATION:
 KTS-AWTM-23-51067-02

SIGNATURE:

SIGNATURE:

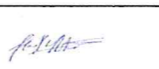
SIGNATURE:

PROJECT LOCATION:
 LAVERTON BYPASS,
 LAVERTON

TITLE:
 REMEDIATION WORKS

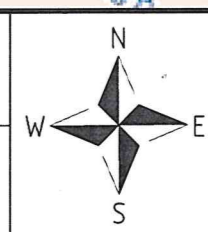

PROJECT NUMBER: 441073298
SHEET NUMBER: 03
REVISION NUMBER: 0